

STR Series

HOUSINGS
BASKET FILTERS
LOW PRESSURE



MAIN APPLICATIONS:

- DESALINATION
- WATER TREATMENT
- PETROCHEMICAL
- FINE CHEMICAL
- FOOD & BEVERAGE
- POWER GENERATION
- PAINTS AND RESINS
- PHARMACEUTICAL
- MICROELECTRONIC
- GALVANIC
- HYDRAULIC
- STILL MILL
- GENERAL INDUSTRY

CHARACTERISTICS:

- 100% AISI 31L construction.
- Micro-cast V-Clamp closure.
- Conform to 2014/68/UE PED Directive.
- Conform to 2014/34/UE ATEX Directive.
- 1935/2004/CE certification available upon request.
- Suitable for liquids Gr. 1 and 2 filtration.
- Suitable for basket size 1, 2, 3, 4.
- Side inlet bottom outlet nozzles design.
- Suitable for pressure up to 8 bar.
- O-ring body/head seal.
- Basket suitable for Delta-P up to 4 bar.
(10 bar Delta-P design available as option).
- 430-SS adjustable legs (in option for size 1 and 2 version).
- Hydraulic test on 100% of manufactured filters.
- Customization for OEM available.

ASCO FILTRI

a **mott** company

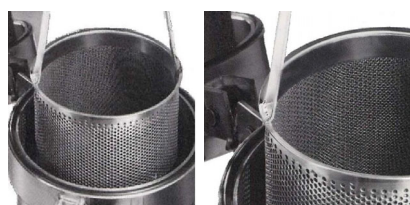

ASCO Filtri S.p.A.

Viale delle Scienze, 8

20082 Binasco (MI) - Italy

Phone: +39 02 89703.1

Fax: +39 02 89703.410

E-mail: info@ascofiltri.com

Web: www.ascofiltri.com

STR Series

HOUSINGS
BASKET FILTERS
LOW PRESSURE

TECHNICAL DATA

MAX. WORKING CONDITION
8 bar @ 80 °C

CONSTRUCTION MATERIALS

- BODY:**
- 316L-SS
V-CLAMP:
- 316-SS micro cast
ADJUSTABLE LEGS:
- 430-SS (option)

FINISHING

- **A38:**
Internal electropolishing
External manual polishing
- **A44:**
Int./ext. glass bead blast

GASKETS

- **EPDM** max. 120 °C
- **Viton** max. 230 °C
- **Silicone** max. 230 °C
- **FEP** max. 250 °C

IN/OUT

- 1.1/2" GAS-M
- 2" GAS-M
- 2.1/2" GAS-M
- 3" GAS-M

VENT

- 3/8" GAS-F

ACCESSORIES

- Pressure gauge
- Vent valve
- Flanged connections
- magnetic candles kit

Dimensions:

Model	Q max.	Dimensions [mm]					In/out	Vol. [lt]	Weight [kg]	Fig.
	m ³ /h	A	B	C	D	E				
STR013	9	114.3	95	-	257	60	1.1/2" Gas-m	2.6	8	2
STR014	15	114.3	95	-	402	60	1.1/2" Gas-m	3.7	9	2
STR011	20	204	170	[1]	479	120	2" Gas-m	16	26	1
STR012	35	204	170	[1]	864	120	2" Gas-m	28	30	1

Max. flow-rate referred to 100 µm basket. Initial Delta-P 0.15 bar. Fluid: water.
Suggested flow-rate change according to the installed filtration rating.
1] "C" dimension adjustable, according to the selected model.

FIG.1

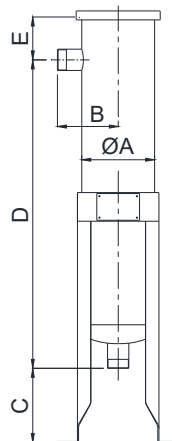
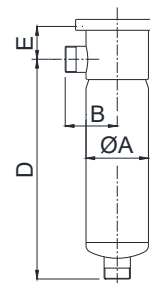

FIG.2



Max. working pressure:

Fluid	Model			
	STR013	STR014	STR011	STR012
Liquid Gr. 2	8 bar	8 bar	8 bar	8 bar
Liquid Gr. 1	8 bar	8 bar	8 bar	7 bar
Gas Gr. 2	Not suitable			
Gas Gr. 1				

Where the 2014/68/UE PED Directive is applicable, in case of dangerous liquids Gr. 1, the max. working pressure must be reduced. For different pressures contact ASCO Filtri.

Contact us for any further information.

We reserve the right to change the data of this specification without notice.

ASCO Filtri S.p.A.

Viale delle Scienze, 8
20082 Binasco (MI) - Italy

Phone: +39 02 89703.1

Fax: +39 02 89703.410

E-mail: info@ascofiltri.com

Web: www.ascofiltri.com

ASCO
FILTRI
a **mott** company